

# HTB 薄型油压 SD. SW

Bore:  $\varnothing 20$ - $\varnothing 80$ mm · Pmax: 140kg/c m<sup>2</sup>

## 訂購標示法

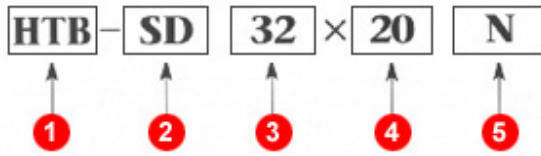

1	系列名称	HTB	
2	安装型式	SD	轴向 单轴
		SW	轴向 双轴
3	油缸内径	$\varnothing 20$ . $\varnothing 25$ . $\varnothing 40$ . $\varnothing 50$ . $\varnothing 63$ . $\varnothing 80$	
4	标准行程	请参考行程规格表	
5	轴端型式	内牙: N 外牙: W	

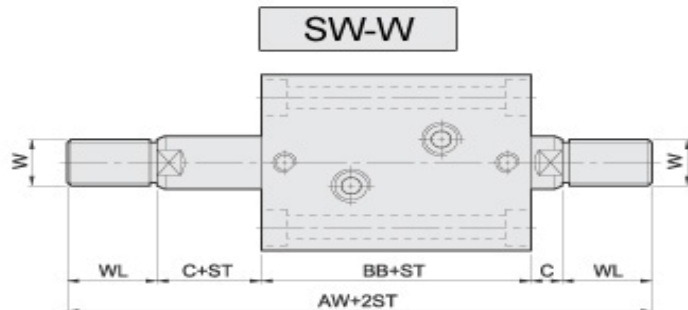
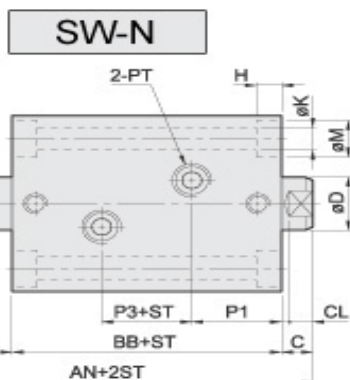
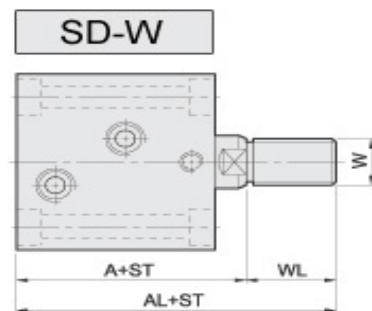
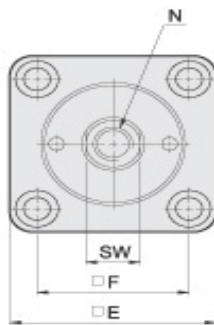
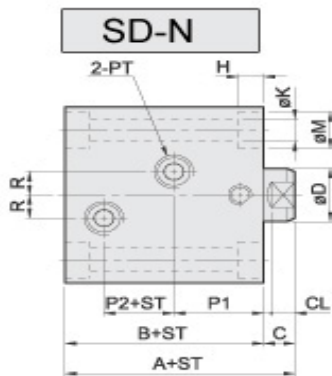

ST=Stroke

## 尺寸规格表

Bore	A	AL	AN	AW	B	BB	C	CL	D	SW	E	F	H	K	M	N	W	WL	P1	P2	P3	R	PT
$\varnothing 20$	51	71	—	—	43	—	8	6	12	10	42	30	5.5	5.6	9	M8x1.25x12D.	M10x1.25	20	22.5	11	—	5	1/8
$\varnothing 25$	53	75	—	—	45	—	8	6	14	12	48	36	5.5	5.6	9	M10x1.5x15D.	M12x1.25	22	23	12	—	5	1/8
$\varnothing 32$	64	89	89	139	54	69	10	7	20	17	62	47	6.5	6.8	11	M12x1.75x15D.	M16x1.5	25	28	14	13	10	1/4
$\varnothing 40$	65	95	90	150	55	70	10	7	25	22	70	52	9	9	14	M16x2.0x20D.	M22x1.5	30	28	15	14	10	1/4
$\varnothing 50$	71	106	97	167	60	75	11	8	30	27	80	58	11	11	18	M20x2.5x25D.	M26x1.5	35	29.5	18	16	10	1/4
$\varnothing 63$	80	120	108	188	67	82	13	10	35	32	94	69	13	13	20	M27x3.0x35D.	M30x1.5	40	31	20	20	10	3/8
$\varnothing 80$	95	140	127	217	78	93	17	14	45	41	114	86	15	15	22	M30x3.5x35D.	M39x1.5	45	33	27	27	15	3/8