

PTC 齿形螺杆

材质: 本体 S45C 齿型部位 SKH9
 硬度: 本体 HRC35 齿型部位 HRC60



PTC1



PTC2

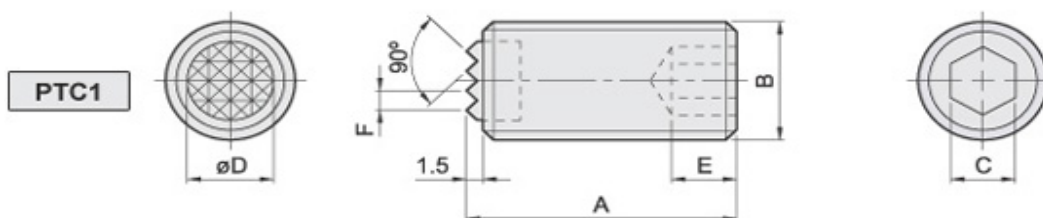

MODEL	A	B	C	D	E	F	g
PTC1-0110	25	M10	5	6.4	4	2.3	15
PTC1-0210	50	M10	5	6.4	5	2.3	30
PTC1-0312	25	M12	6	7.9	5	2.3	22
PTC1-0412	50	M12	6	7.9	5	2.3	45
PTC1-0516	25	M16	8	11.1	6	3	38
PTC1-0616	50	M16	8	11.1	6	3	78
PTC1-0720	25	M20	10	12.7	8	3	58
PTC1-0820	50	M20	10	12.7	8	3	120

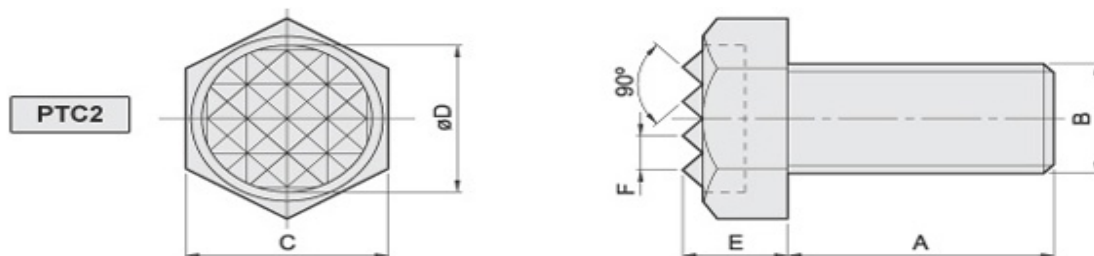

MODEL	A	B	C	D	E	F	g
PTC2-0106	25	M6	10	7.9	5	2.3	8
PTC2-0208	25	M8	13	9.5	6.5	3	15
PTC2-0310	25	M10	17	12.7	8.3	3	30
PTC2-0410	40	M10	17	12.7	8.3	3	35
PTC2-0512	25	M12	19	15.9	8.7	3	35
PTC2-0612	40	M12	19	15.9	8.7	3	50
PTC2-0716	35	M16	24	19.1	11	3	85
PTC2-0816	50	M16	24	19.1	11	3	100
PTC2-0920	40	M20	30	25.4	13.7	3	160
PTC2-1020	60	M20	30	25.4	13.7	3	205

公司地址: 上海市静安区新闻路1161号A1室 邮编200041

电话: 021-51872743 传真: 021-62275540

公司网站: www.fdzc.net E-mail: chengff@sh163.net

联系人: 程家雄

手机: 13601809714